

Attachment A
Letter of Explanation

Beth Fioritto

[REDACTED]
Oak Park, IL 603023

November 15, 2024

The Transportation Commission attn: Steve Pautsch
Village of Oak Park, Public Works Center
201 South Boulevard
Oak Park, IL 60302

Dear Mr. Pautsch and the Transportation Commission:

Thank you for considering our Traffic Calming Petition. The problems we seek to address through this petition are high speeds down Elmwood and Thomas, excessive vehicle collisions (there have been at least two on Elmwood in the 3 years I have lived on Elmwood) as well as pedestrian safety and driver confusion at the intersection of Elmwood Ave and Thomas St. We believe these problems are interrelated and can be solved through traffic calming measures on Elmwood and at the intersection of Elmwood Avenue and Thomas Street. While we look forward to a study and your recommendations, we would like to suggest at the very least a 4-way stop at Elmwood Ave and Thomas St, and additional traffic calming measures aimed at reducing speed on both the 700 and 800 blocks of Elmwood Ave, and on Thomas St.

There is a general consensus among neighbors that the traffic problems around this intersection (and along the streets surrounding it) stem primarily from drivers trying to avoid the Ridgeland/Division intersection (especially during rush hour). We see drivers turning south onto Elmwood from eastbound Division (despite the already-posted sign), from eastbound Augusta north onto Elmwood, or from northbound Ridgeland onto westbound Thomas. We suspect drivers who choose to cut down Elmwood feel an especially strong incentive to do this because there is no stop sign on Elmwood at Thomas Street: not only can they avoid sitting at the Ridgeland stop light by turning down Elmwood, they can also pick up speed for two blocks (from Division to Augusta) because there is no stop sign. We think a 4-way stop at Thomas and Elmwood would make this "shortcut" somewhat less appealing.

Another reason we think the intersection could benefit from a 4-way stop is because drivers often incorrectly assume that it is already a 4-way stop. This creates confusion, which poses a danger to pedestrians, bikes, and drivers, especially if traffic gets heavy (which it does, especially during rush hour).

There has been at least one vehicle collision within the last two years at this intersection. It would not be at all surprising to us if it was a result of either confusion about the stop sign, or reckless high speeds from a driver avoiding the Ridgeland/Division intersection. There has also been at least one other vehicle collision on Elmwood, stemming from a vehicle taking a "shortcut" off of Augusta onto Elmwood.

We also seek traffic calming to help with high traffic speeds and traffic volume. We definitely see increased volume during rush hour, which we think will likely meet the standard for excessive volume. However the most pressing issue is excessive speed. We frequently see drivers going as fast as 40mph down Elmwood Ave. We'd be interested in measures to reduce vehicle speeds, including speed feedback signs, or perhaps even speed humps or bulbouts.

While collecting signatures, I learned that neighbors from these blocks have petitioned for traffic calming many times over the years. Traffic safety seems to be an ongoing concern in this area. We hope the frequency of requests can weigh into your decision to take action on our petition. I would be happy to discuss these concerns further; I think there are ways to improve the safety of this area beyond this intersection that I would love to share, including lowering the prevailing speed limit throughout the village.

Thank you for considering our petition. We look forward to hearing from you.

Sincerely,

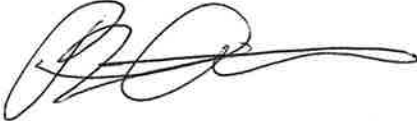
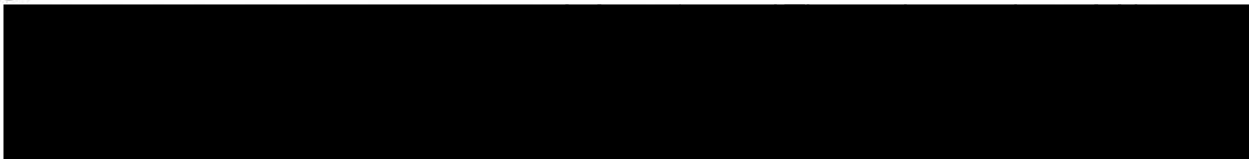
A handwritten signature in black ink, appearing to be the initials 'P.A.' followed by a long, sweeping horizontal line.

Attachment B
Public Testimony

[REDACTED]

From: [REDACTED]
Sent: Sunday, May 25, 2025 12:13 PM
To: Transportation
Cc: Ann Barkley
Subject: Traffic calming devices at intersection of N. Elmwood and Thomas

Caution! This message was sent from outside your organization.

To whom it may concern

Thank you for following through on the petition we submitted regarding excessive speeding on the 800 block of North Elmwood.

We have lived at [REDACTED] since 1987 and have witnessed some pretty bone-headed driving by individuals, most likely, trying to avoid the traffic lights at Ridgeland and Division. The same can be said of people crossing Ridgeland at Thomas to effectively do the same.

What makes it even more dangerous is the fully tinted windows (excluding the front window) that seem to be allowed now. My wife and I are retired and walk our dogs in our neighborhood and can't be sure the drivers even see us. There is no opportunity to establish eye contact. Add to this the number of people on Thomas who run the stop sign going east or west every day, all day long.

I like the Neck-down/ Bulb-out option on all four directions. I see them at Taylor park as well as River Forest and think they would do the trick while adding an attractive element to this historic district.

Thank you for your concern and your service, John M. Barkley

[REDACTED]

Sent from my iPad

Pautsch, Steve

From: elizabeth moss [REDACTED]
Sent: Wednesday, June 4, 2025 4:22 PM
To: Transportation
Subject: Support of traffic calming at intersection of N. Elmwood and Thomas

Caution! This message was sent from outside your organization.

I am writing in strong support of the implementation of traffic calming devices at the intersection of N. Elmwood and Thomas, as this intersection currently only has stop signs on Thomas. I support the traffic calming measure as N. Elmwood is heavily used as a cut-through method to avoid the traffic light at Ridgeland and Division. The lack of a stop sign allows cars to speed through both blocks of Elmwood. This creates a dangerous intersection for bikers and walkers at Thomas and Elmwood, as well as continuing problems at the intersection of Elmwood and Division. There are numerous families with young children on that walk to the elementary school. Elmwood is also a very popular route for people with dogs, bikes, and baby carriages to use to go to Taylor Park. Traffic calming would slow down the speeding cars, and also ensure that the intersection of Elmwood and Thomas is safer. Even while sitting here, writing this email, I have lost count of the number of cars speeding down Elmwood, just to avoid the light. Please implement measures to slow down the traffic and make this street safer!

Thank you!

Elizabeth Moss

[REDACTED] Elmwood Ave

Pautsch, Steve

From: Amanda Zoloto [REDACTED]
Sent: Wednesday, June 4, 2025 4:34 PM
To: Transportation; Pautsch, Steve
Subject: Traffic Calming at Elmwood and Thomas

Caution! This message was sent from outside your organization.

Hello,

I am the homeowner at [REDACTED] Elmwood, the corner of Elmwood and Thomas in Oak Park. While I will not be able to attend the meeting on June 9, I want to offer my support for traffic calming measures at this intersection. I have owned this home for 15 years and can attest to the dangerous collisions and near collisions that happen daily. As someone who works from home, I hear the traffic incidents and have had to rush outside to check on pedestrians, bikers and drivers immediately after collisions or very close calls. Most often, drivers just don't realize it's not a 4-way stop and speed through despite oncoming traffic.

We are in need of traffic calming measures. Please feel free to reach out to me with follow up questions.

Sincerely,

Amanda Zoloto, MSW, LSW

[REDACTED] Elmwood Ave Homeowner

Attachment C

Aerial Images

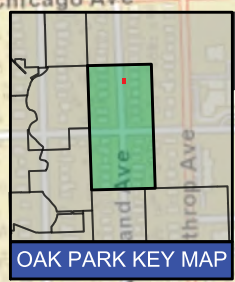
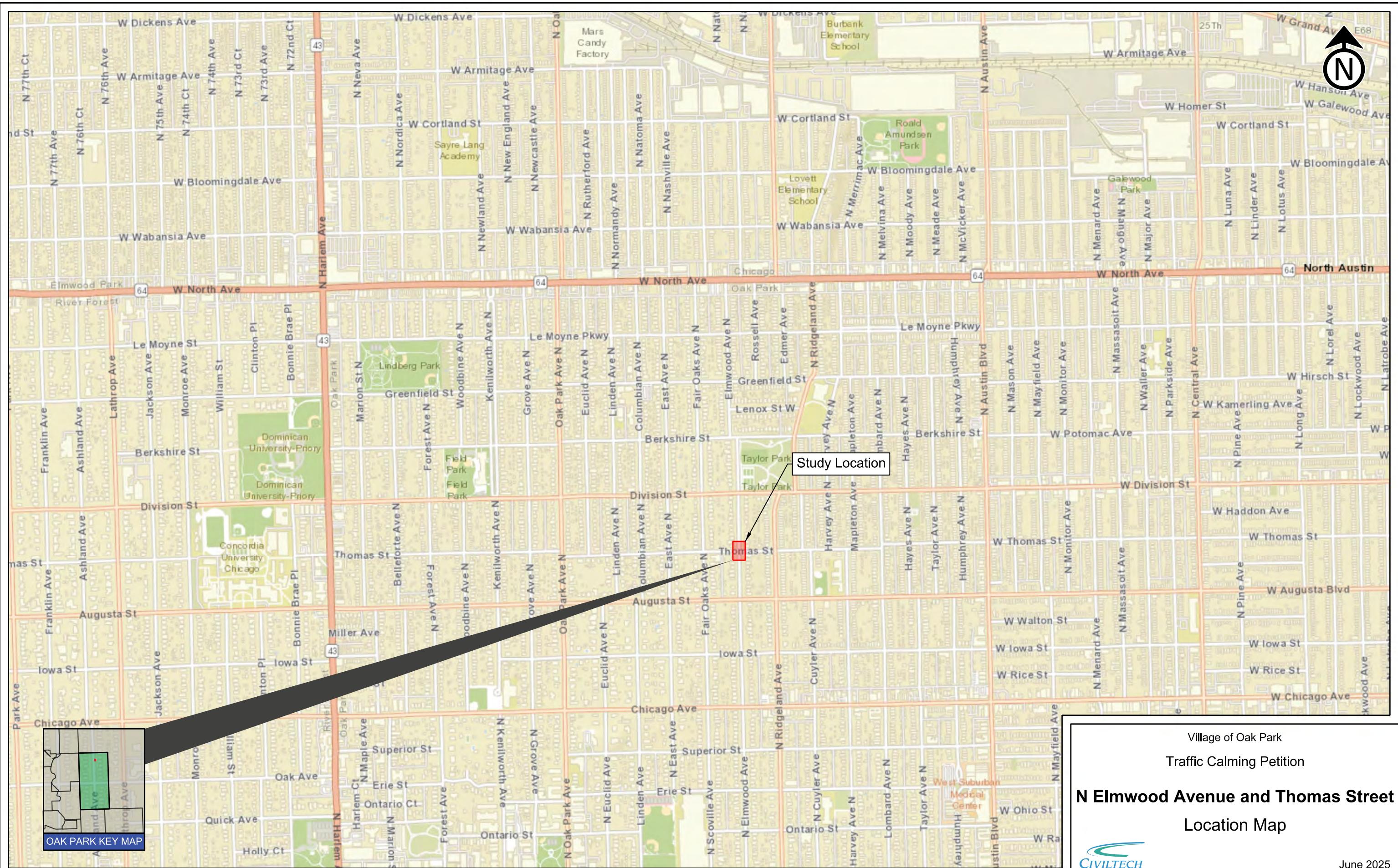





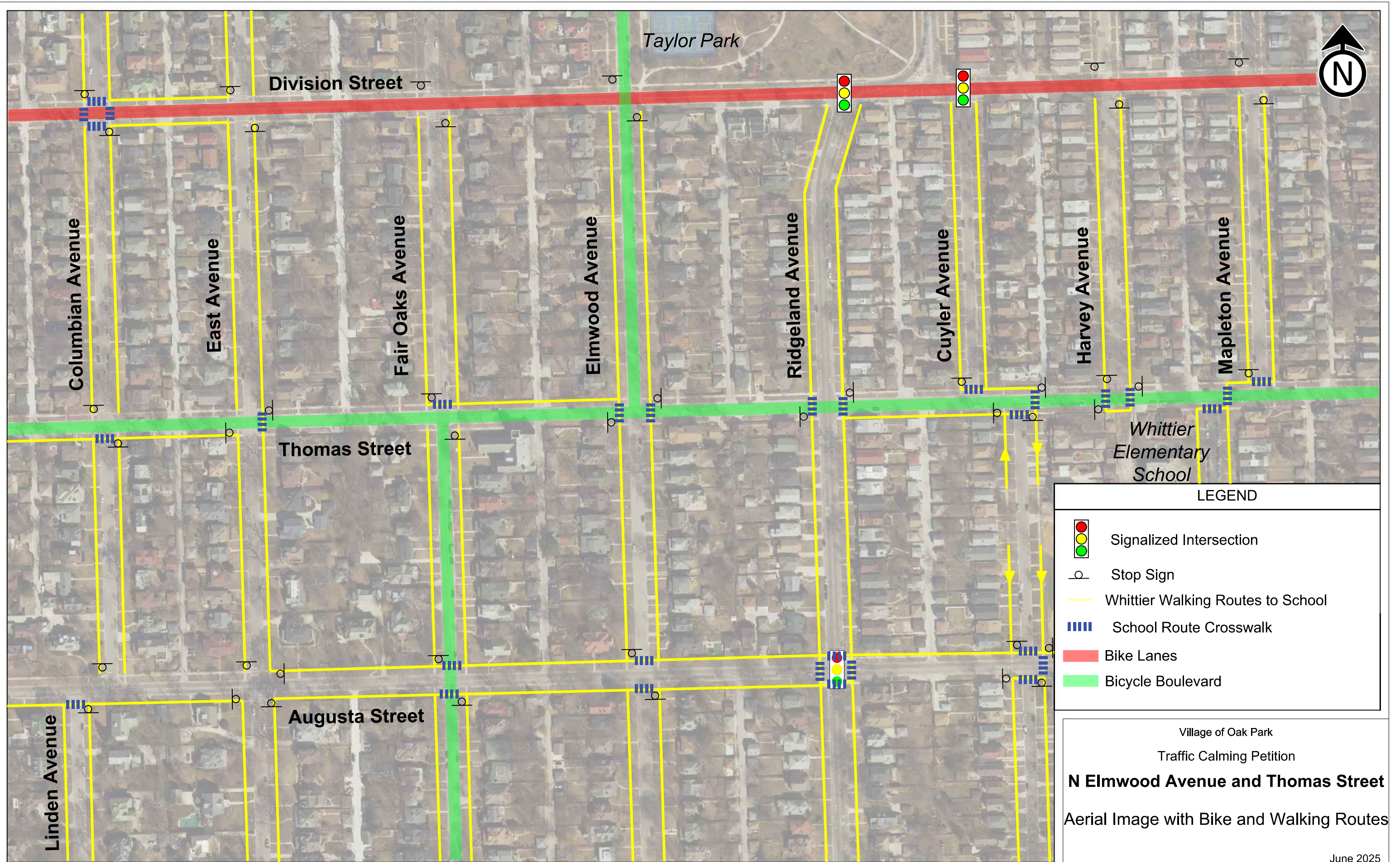

Village of Oak Park
 Traffic Calming Petition
N Elmwood Avenue and Thomas Street
 Location Map



June 2025



LEGEND

-  Signalized Intersection
-  Stop Sign
-  Whittier Walking Routes to School
-  School Route Crosswalk
-  Bike Lanes
-  Bicycle Boulevard

Village of Oak Park
 Traffic Calming Petition
N Elmwood Avenue and Thomas Street
 Aerial Image with Bike and Walking Routes

June 2025

**Attachment D
Speed and
Volume Data**

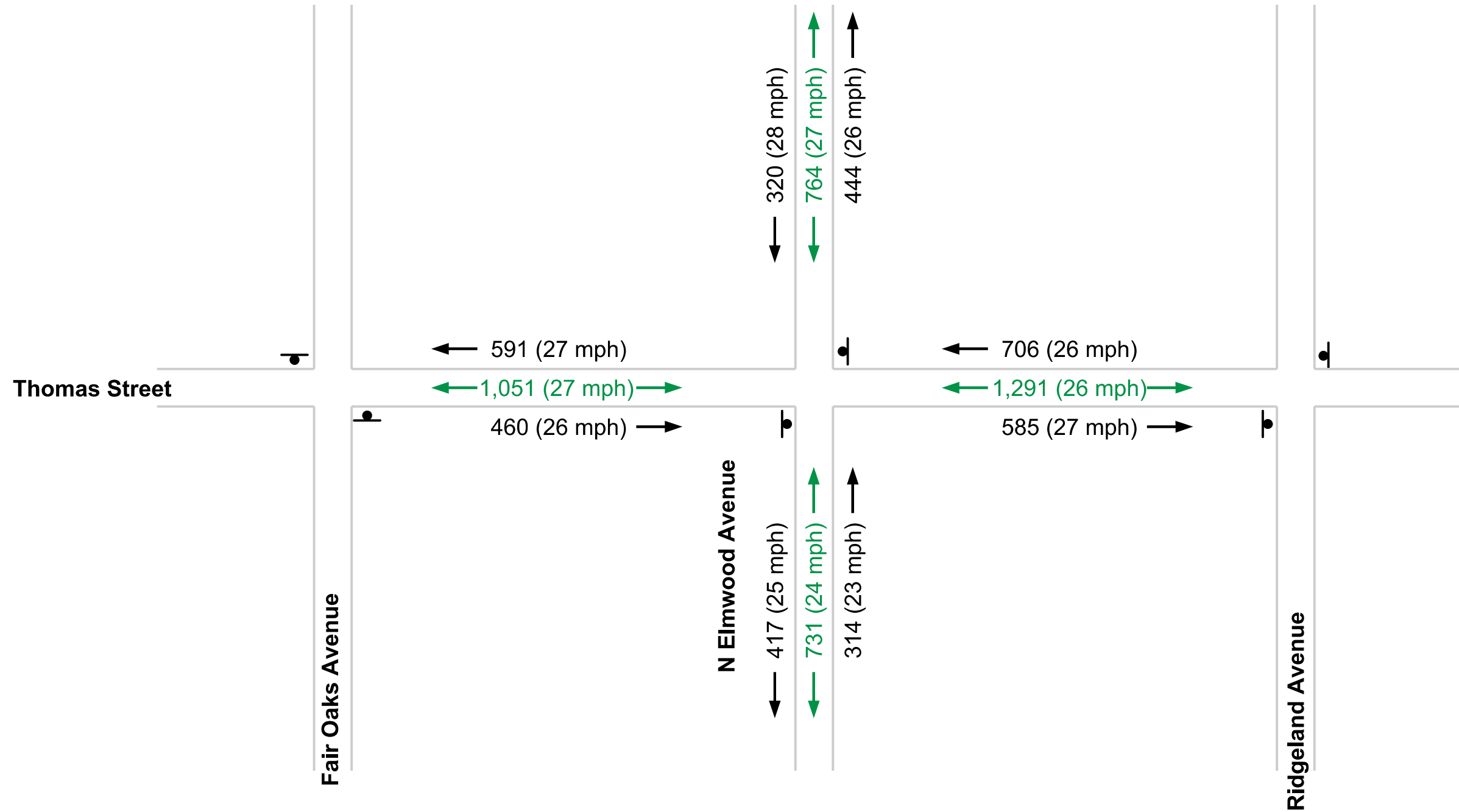

LEGEND

- Count Date: April 1, 2025 (Tuesday)
- ← XXX (YY mph) → Bi-Directional Volume (85th Percentile Speed)
- XXX (YY mph) → Volume (85th Percentile Speed)
- Stop Sign

Village of Oak Park
 Traffic Calming Petition
ADT and Speed Data
 N Elmwood Avenue and Thomas Street



June 2025
 Not to Scale

Attachment E
Turning Movement
Counts



Wkday A.M. (P.M.) Traffic Counts

Wkday A.M. (P.M.) Ped. Counts



Thomas Street



Elmwood Avenue

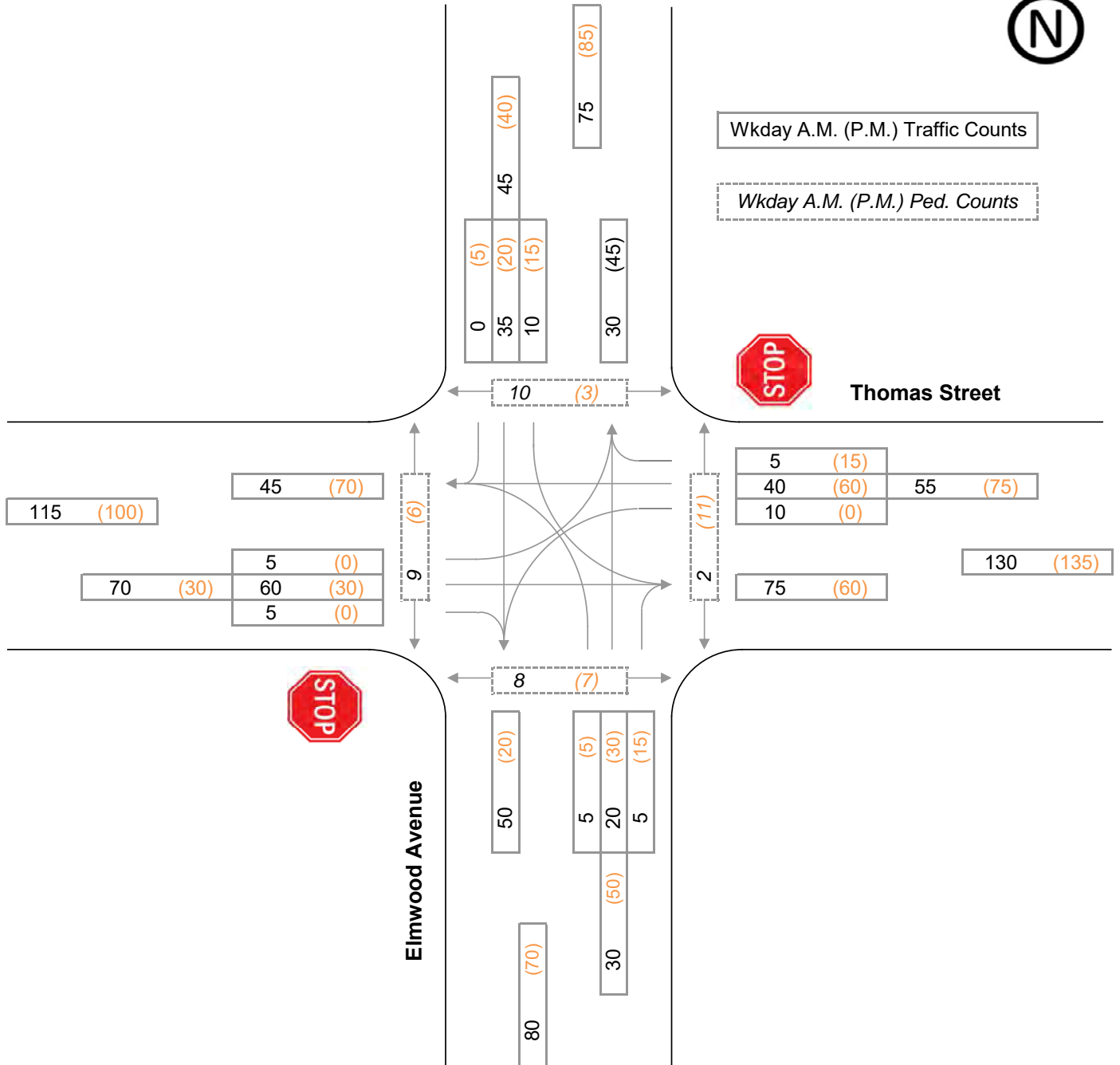

Vehicle Traffic Peak Hours:

7:15 A.M. to 8:15 A.M.

5:00 P.M. to 6:00 P.M.

Count Date(s):

Tuesday, April 1, 2025

Village of Oak Park

Oak Park Traffic Calming

2025 Existing Peak Hour Traffic

Elmwood and Thomas Street





Wkday A.M. (P.M.) Bicycle Counts

Wkday A.M. (P.M.) Ped. Counts



Thomas Street



Elmwood Avenue

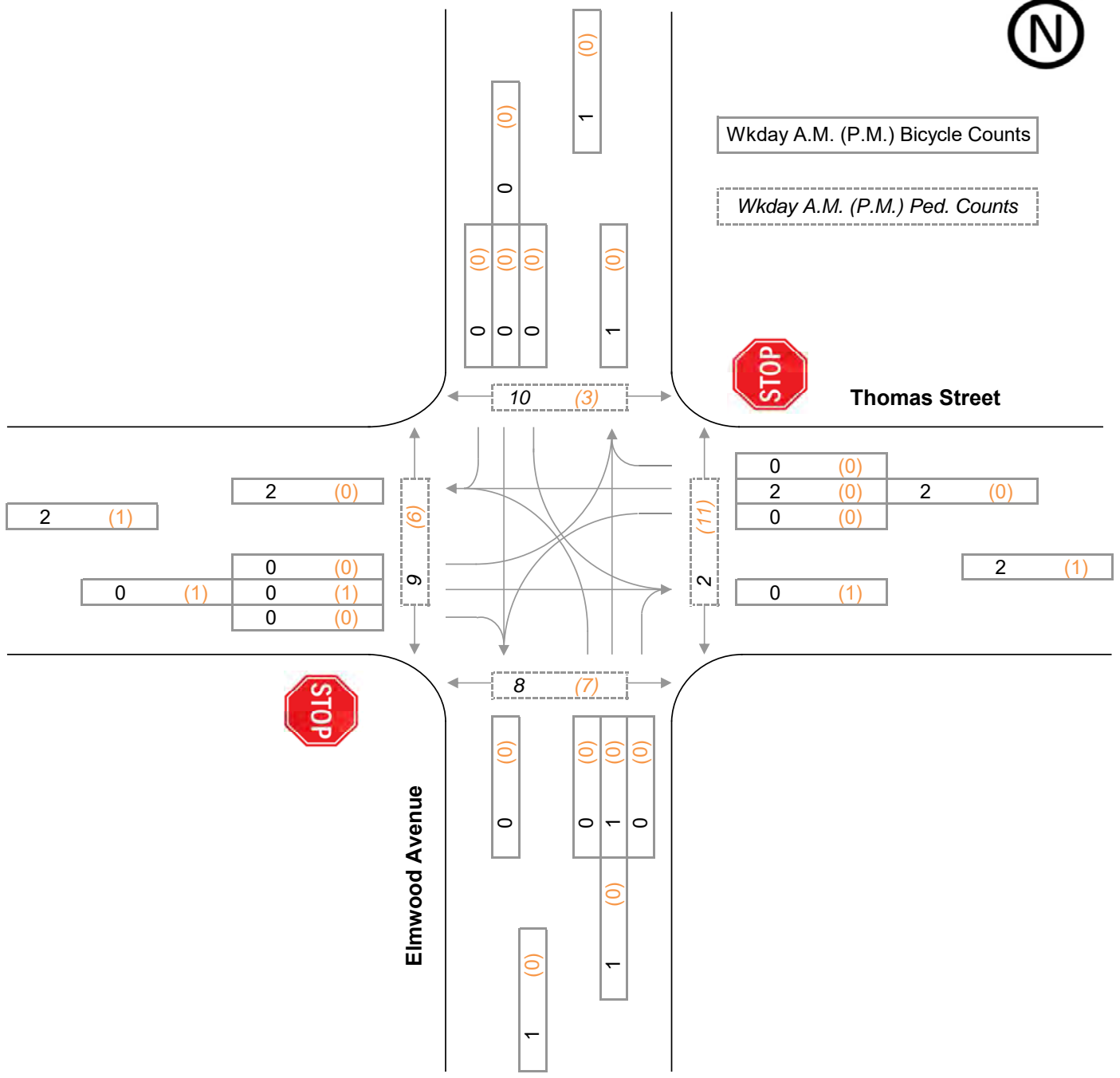

Vehicle Traffic Peak Hours:
 7:15 A.M. to 8:15 A.M.
 5:00 P.M. to 6:00 P.M.

Count Date(s):
 Tuesday, April 1, 2025

Village of Oak Park
 Oak Park Traffic Calming

2025 Existing Peak Hour Bicycle Traffic

Elmwood and Thomas Street





Wkday A.M. (P.M.) Traffic Counts

Wkday A.M. (P.M.) Ped. Counts



Thomas Street

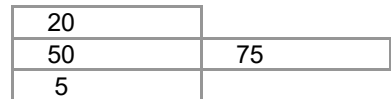

125

50

Elmwood Avenue



9

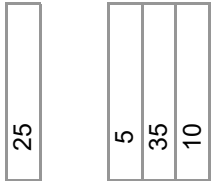

75



100

55

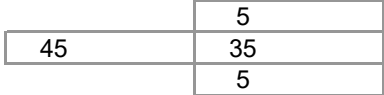

1

3

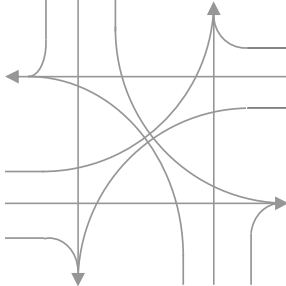

5

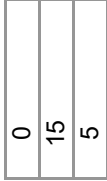

80



Vehicle Traffic Peak Hour:
3:00 P.M. to 4:00 P.M.

Count Date(s):
Tuesday, April 1, 2025

Village of Oak Park

Oak Park Traffic Calming

2025 Existing P.M. School Traffic Hour

Elmwood Avenue and Thomas Street



Attachment F

Crash History



KEY
(xx/xx/xx, hh:mm, YZ, A): Date, Time, Weather Pavement Condition, Injury
Red: Injury Crash Blue: Non-Intersection Crash

LEGEND	
Right Angle Collision	
Stop Sign	
<u>Date:</u> Month/Day/Year	<u>Pavement:</u> D=Dry, W=Wet, I=Icy
<u>Time:</u> 00:00 (Military Time)	<u>Weather:</u> C=Clear R=Rain F=Fog S=Snow
<u>Injury:</u> K=Fatal, A=Incapacitated, B=Non-Incapacitating, C=Not Evident	

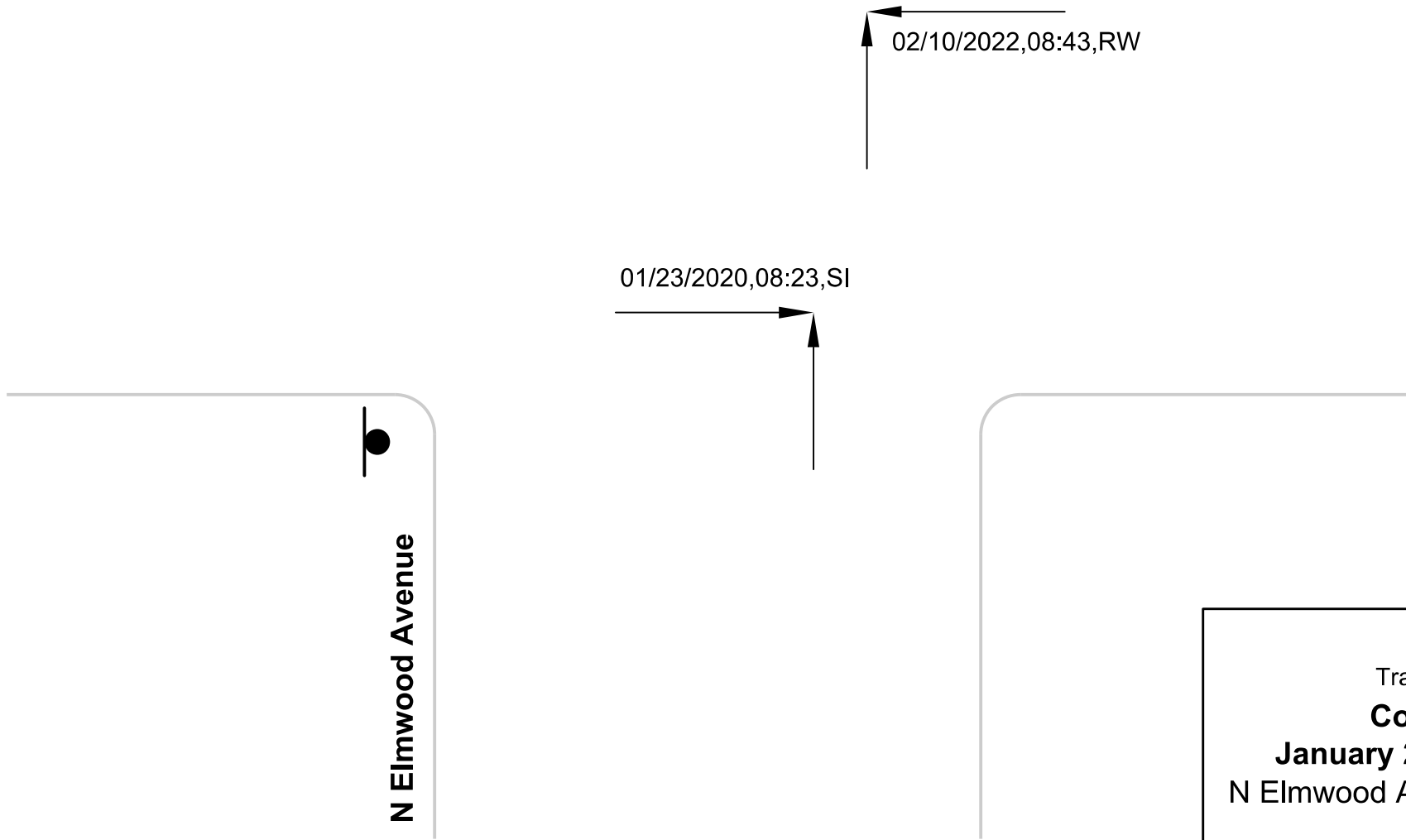

Village of Oak Park
 Traffic Calming Petition
Collision Diagram
January 2020 - December 2024
 N Elmwood Avenue and Thomas Street



June 2025

Attachment G
Recommended Improvements

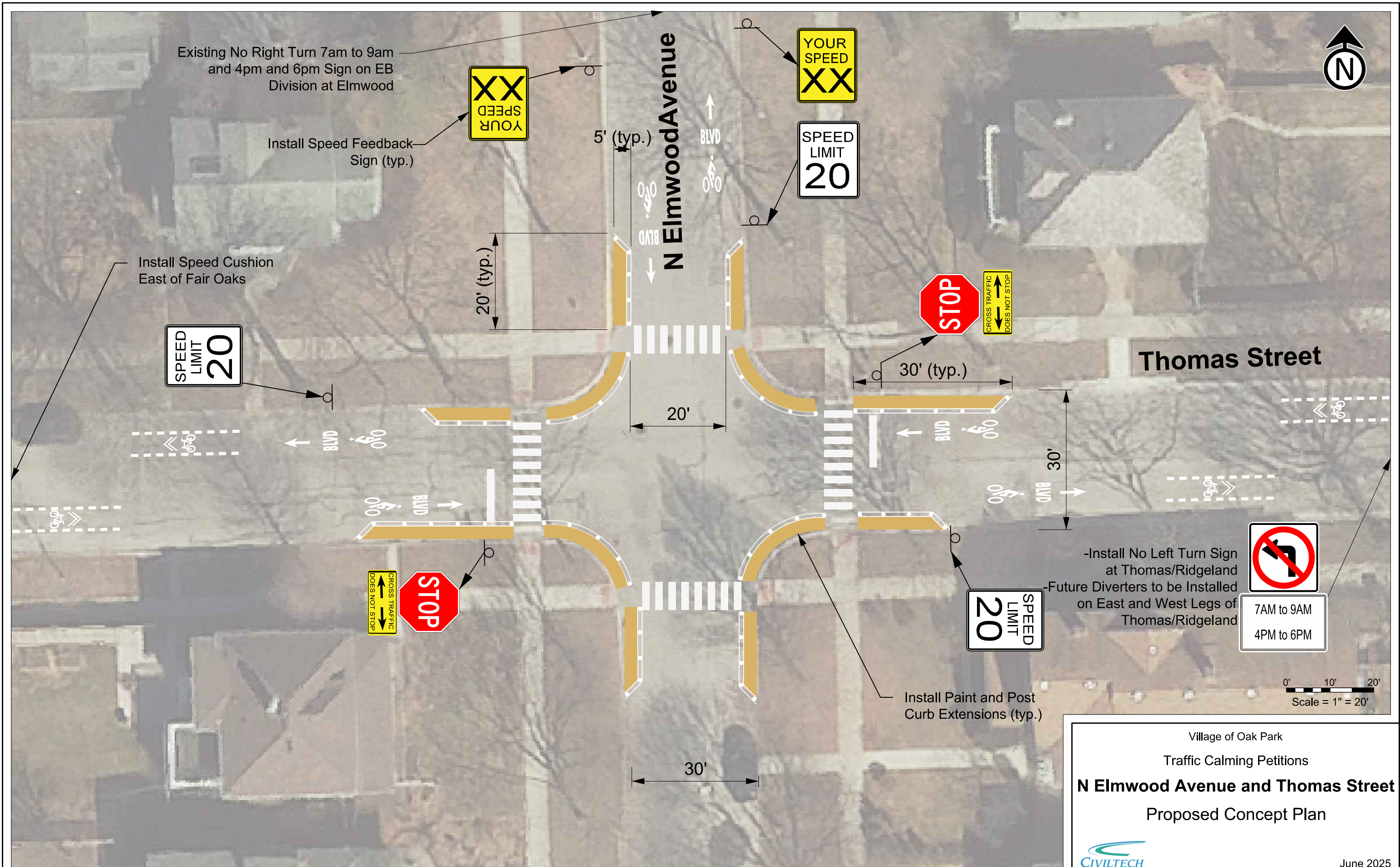

Village of Oak Park
 Traffic Calming Petitions
N Elmwood Avenue and Thomas Street
 Proposed Concept Plan

CIVILTECH

June 2025



Paint and Post Curb Extension Example

Attachment H
Meeting Minutes

Approved Minutes
Transportation Commission
Oak Park Village Hall
June 9, 2025
7:00 p,m

PRESENT: Chair Burke, Commissioners Jenkins, Johnston-Ahlen, Johnson, Johnston-Ahlen, Commissioner Eskin

ABSENT: NONE

STAFF PRESENT: Assistant Village Engineer Chris Welch, CivilTech Consultant Kristen Hahn

Roll Call: Chair Burke called the meeting to order at 7:04 p.m.

Ron Burke	Present
Jack Eskin	Present
Jenna Holzberg	Absent
Jason Jenkins	Present
Erika Johnson	Present
Julie Johnston-Ahlen	Present
Jason Nudelman	Absent

Agenda Approval: Commissioner Julie Johnston-Ahlen made a motion and commissioner Jason Jenks seconded it. – Vote passed unanimously

Approval of Transportation Commission Meeting Minutes: commissioner Jason Jenkins made a motion and commissioner Jack Eskin seconded it. – Vote passed unanimously

Non-Agenda Public Comment: Elizabeth Wren from the 300 Block of South Wesley made a public comment about available overnight parking permits on her block in permit area Y5.

New Business

- a) Elmwood and Thomas Traffic Calming Petitions

CivilTech Consultant Kristen Hahn gave a summary of peak hour rush hour for traffic and pedestrian data. Data shows traffic is higher around school hours. Another type of data is mid-block data over 3 days 85% of cars are going the correct speed in this area. Crash data was also evaluated and there was nothing to show high aggression in car accidents. Recommendations would be paint and post

bump outs at all four corners of the intersection to go with the proposed neighborhood greenway treatments the area is already scheduled to receive in 2026. A non-exhaustive list of these treatments includes a diverter at Thomas and Ridgeland preventing all movements except right turns onto and off of southbound Ridgeland, a speed feedback sign on the 800 block of Elmwood, a speed cushion west of the intersection on Thomas and a pavement marking and greenway signage. A temporary no left turn from 4-6 pm sign on northbound Ridgeland is also proposed as an interim condition prior to the construction of the Diverter.

Public Comment:

Beth Fioretto from the 800 block of Elmwood spoke in support of the proposed changes

Jesse Driscoll from the 700 block of Elmwood spoke in support of the proposed changes

Jennifer Driscoll from the 700 block of Elmwood spoke in support of the proposed

The Commission discussed the placement of the speed cushion on Thomas, preferring it to be to the east of the intersection closer to Ridgeland and asked about adding a speed cushion to the 800 block of Elmwood near Division.

Comissioner Esking gave a Motion to approve the proposed plan with the addition of the Speed Cushion on the 800 block of Elmwood and locating the proposed Thomas Speed Cushion East of the intersection of Thomas and Elmwood. Motion was seconded by Commissioner Jason Jenkins and passed unanimously.

Old Business

-Chair Burkes final commission meeting of his second term will be the July Transportation Commission and the replacement or extension of the Chair were discussed.

-Status of Bike Plan Update was discussed; namely that the next step had not been finalized at this time and it was possible the vote could be delayed from its tentative July 1, 2025 date.

Commissioner Jenkins motioned to adjourn which was seconded by Commissioner Jack Eskin and passed unanimously.

Adjourn 7:59 pm